



IQTouch TE1100 Pro



Data Sheet

- **The advanced Android 11.0**
Latest Android version on IFP, faster processing speed and more stable performance.
- **4K UHD display with zero bonding**
Support for all-channel 4K UI display with high brightness and high contrast.
- **Video Collaboration**
Integrating 4K camera and 8-array microphone to set up a video conference.
- **USB-C connectivity**
Instantly connect your own device for hassle-free presentations via a single-cable solution for touch, audio, video, and power.
- **BYOD**
Easy to share the ideas and collaborate with the rest of the team by wireless screen sharing.



IQTouch TE1100 Pro Specifications

Display

| Model | LE065MD | LE075MD | LE086MD |
|----------------------|--|---------|---------|
| Diagonal Size | 65" | 75" | 86" |
| Brightness | 350cd/m ² | | |
| Contrast Ratio | 5000:1 | | |
| Panel Type | TFT | | |
| Backlight | Direct LED (DLED) | | |
| Resolution | 4K UHD (3840*2160) | | |
| Aspect Ratio | 16:9 | | |
| Response Rate | 6m/s | | |
| Refreshing Frequency | 60Hz | | |
| Viewing Angle | 178° (H), 178° (V) | | |
| Backlight Life Time | 50,000 hrs | | |
| Display Colors | 10bit(1.07B) | | |
| Glass | 4mm Anti-Glare Tempered Glass with Zero Bonding (MOHS 7) | | |

Interactivity

| | |
|----------------------|---|
| Touch Technology | Infrared |
| Touch Point | 20-point touch/writing |
| Touch Resolution | 32768 x 32768 |
| Response Rate | <4ms(single touch) <6ms(max touch inputs) |
| Touch Accuracy | ≤1mm |
| Recognition | Finger or passive stylus |
| Writing Height | 2mm |
| Minimum Touch Object | 2mm |
| Supported O.S. | HID Support & Win10/Win8/Win7/Mac OS /Android/Chrome OS/Linux |

Power

| | 65" | 75" | 86" |
|---------------|--------------------|-------|-------|
| Voltage | 100-240V, 50-60 Hz | | |
| Maximum Power | ≤250W | ≤350W | ≤450W |
| Standby Power | ≤0.5W | ≤0.5W | ≤0.5W |

Physical Specifications

| | 65" | 75" | 86" |
|---------------------------|----------------------|----------------------|----------------------|
| Net Weight | 40Kg±1 Kg | 56Kg±1 Kg | 66Kg±1 Kg |
| Gross Weight | 46Kg±1 Kg | 70Kg±1Kg | 81Kg±1Kg |
| Product Size (mm) (W*D*H) | 1490* 906*89 | 1712* 1013*89 | 1959* 1170*89 |
| Packing Size (mm) (W*D*H) | 1576* 980*200 | 1800* 1125*200 | 2044* 1262*200 |
| VESA Hole Position (mm) | 4-M8 hole 500*400 | 4-M8 hole 600*400 | 4-M8 hole 800*400 |

Environmental

| | |
|---------------------|--------------------------------|
| Working Temperature | 0°C ~ 40°C |
| Storage Temperature | -20°C ~ 60°C |
| Working Humidity | 20% ~ 80% RH Non-Condensing |
| Storage Humidity | 20% ~ 90% RH Non-Condensing |



Front Buttons

| | |
|----------|-------|
| 1 Button | POWER |
|----------|-------|

Connectivity

| | | |
|------------------------|--|---------------------|
| Front | USB3.0 (Android&PC) | 3 |
| | HDMI IN 2.0 | 1 |
| | Touch-USB | 1 |
| | Type C (USB2.0, Audio&Video, Touch, 15W Power) | 1 |
| Input | RJ45 (10/100MB) | 1 |
| | HDMI 2.0 | 2 |
| | VGA | 1 |
| | Audio | 1 |
| | USB 2.0 | 1 |
| | USB 3.0 | 1 |
| | AV | 1 |
| | RS232 | 1 |
| | YPBPR | 1 |
| | Touch-USB | 1 |
| | Output | HDMI 2.0 (Optional) |
| COAX SPDIF | | 1 |
| AV | | 1 |
| EARPHONE | | 1 |
| Built-in Camera | 13MP (4K) | |
| Array Microphone | 8 | |
| Speakers | 15W*2 | |
| Light Sensor | YES | |
| Temperature Monitor | YES | |

Language

| | |
|-----|---|
| OSD | English, Arabic, Spanish, French, Italian, Japanese, Portuguese, Russian, Korean, German, Simplified Chinese, Traditional Chinese |
|-----|---|

Android

| | |
|---------------------|---|
| CPU Framework | Quad-core A55 |
| CPU Processor Speed | 2.0GHz |
| GPU | Mail G52MP2 |
| RAM | 4GB DDR4 |
| ROM | 32GB EMMC |
| OS Version | Android 11.0 |
| IQ OS | YES |
| Hotspot | YES |
| WiFi | 802.11 a/b/g/n/ac embedded (2.4G/5G Dual Module) |
| Bluetooth | 5.0 |

OPS (Optional)

| | |
|---------------|---------------------|
| Chipset | Intel |
| CPU | Intel®Core i3/i5/i7 |
| Memory | 4GB/8GB/16GB |
| HDD | 500GB/1TB |
| SSD(optional) | 128GB/256GB/512GB |

OPS Interfaces (Subject to model)

| | |
|----------|---|
| USB2.0 | 2 |
| USB3.0 | 2 |
| LAN | 1 |
| HDMI | 1 |
| LINE-OUT | 1 |
| MIC-IN | 1 |



IQTouch TE1100 Pro 65inch Dimension

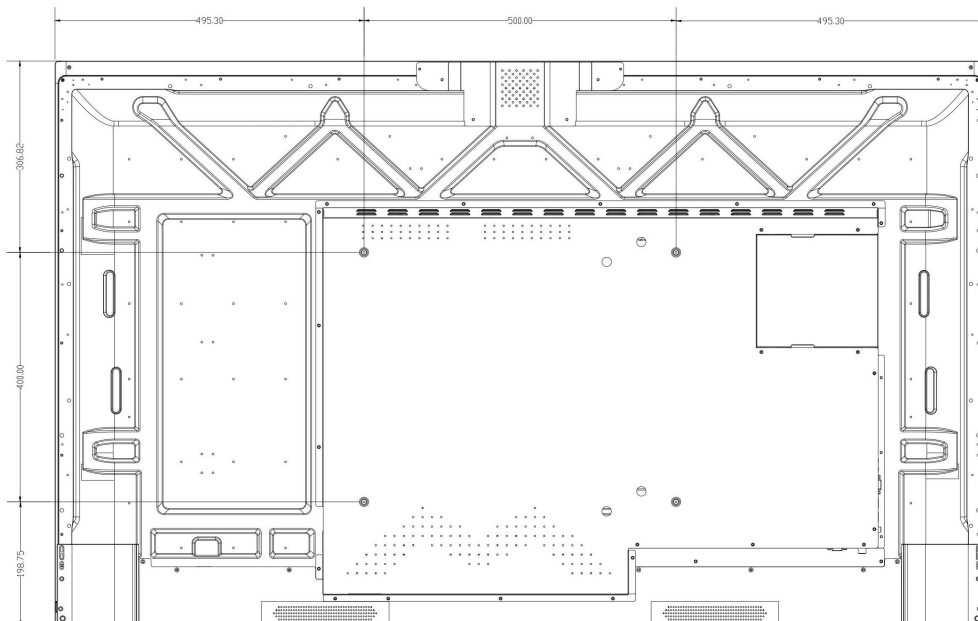
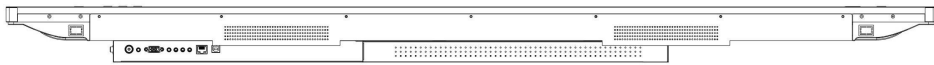
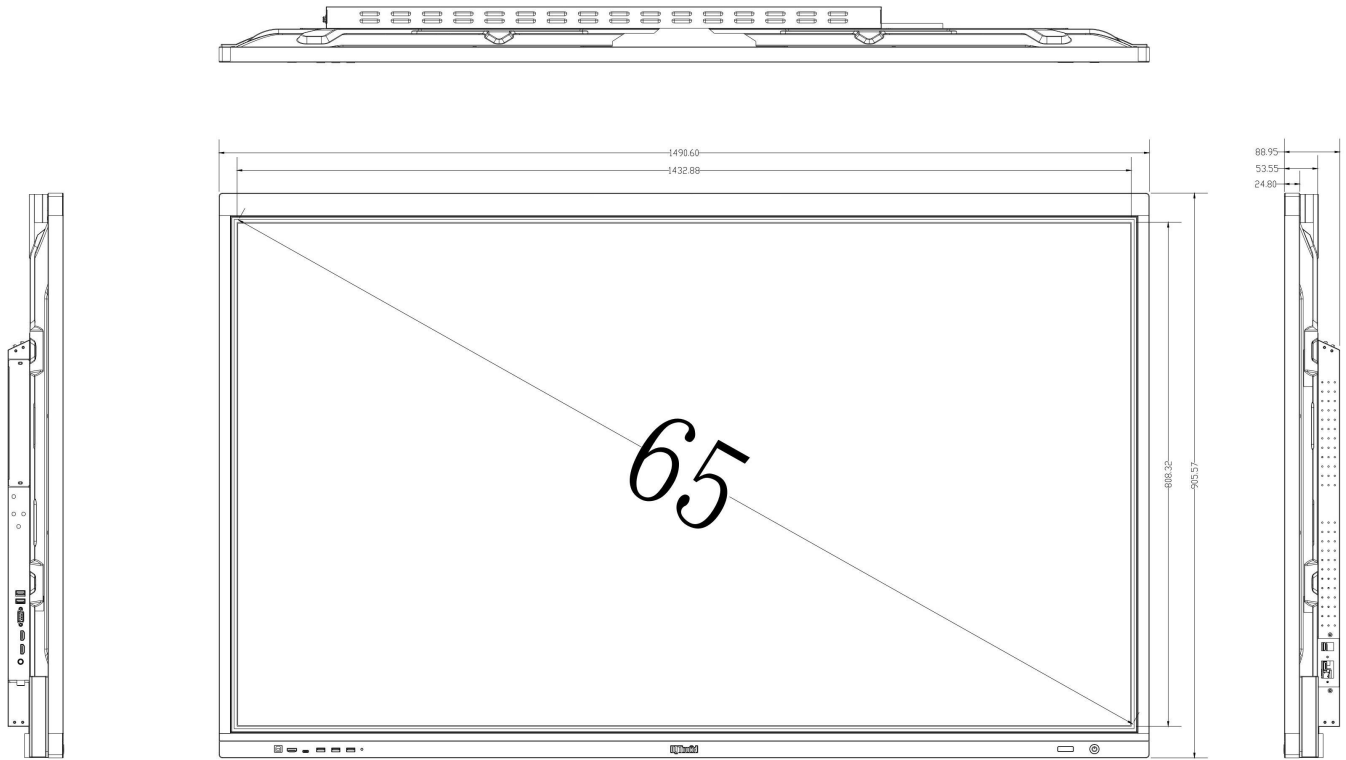



IQTouch TE1100 Pro 75inch Dimension

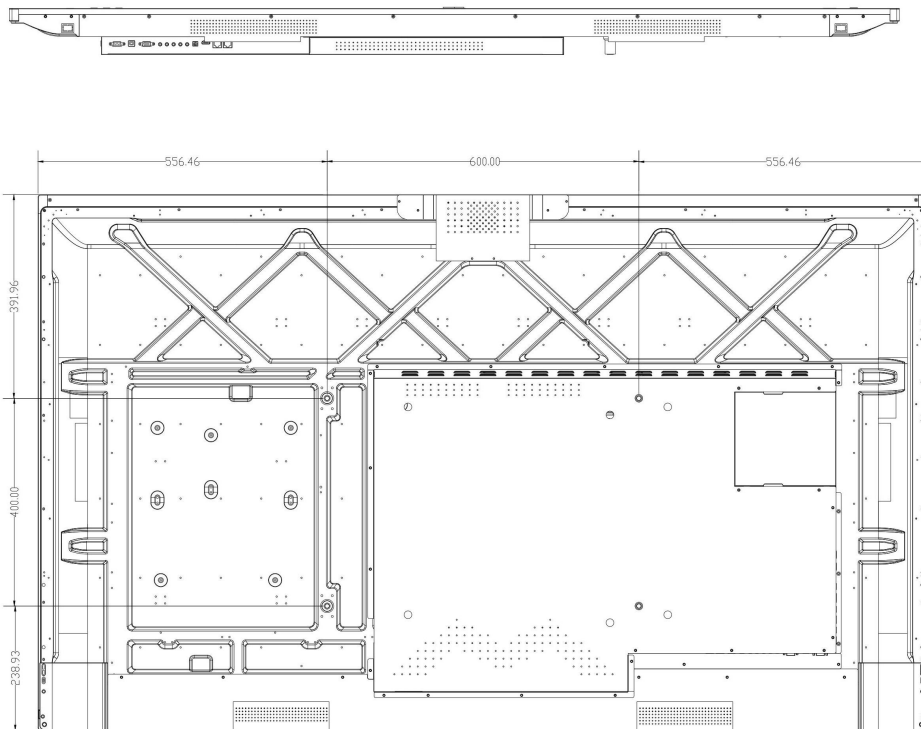
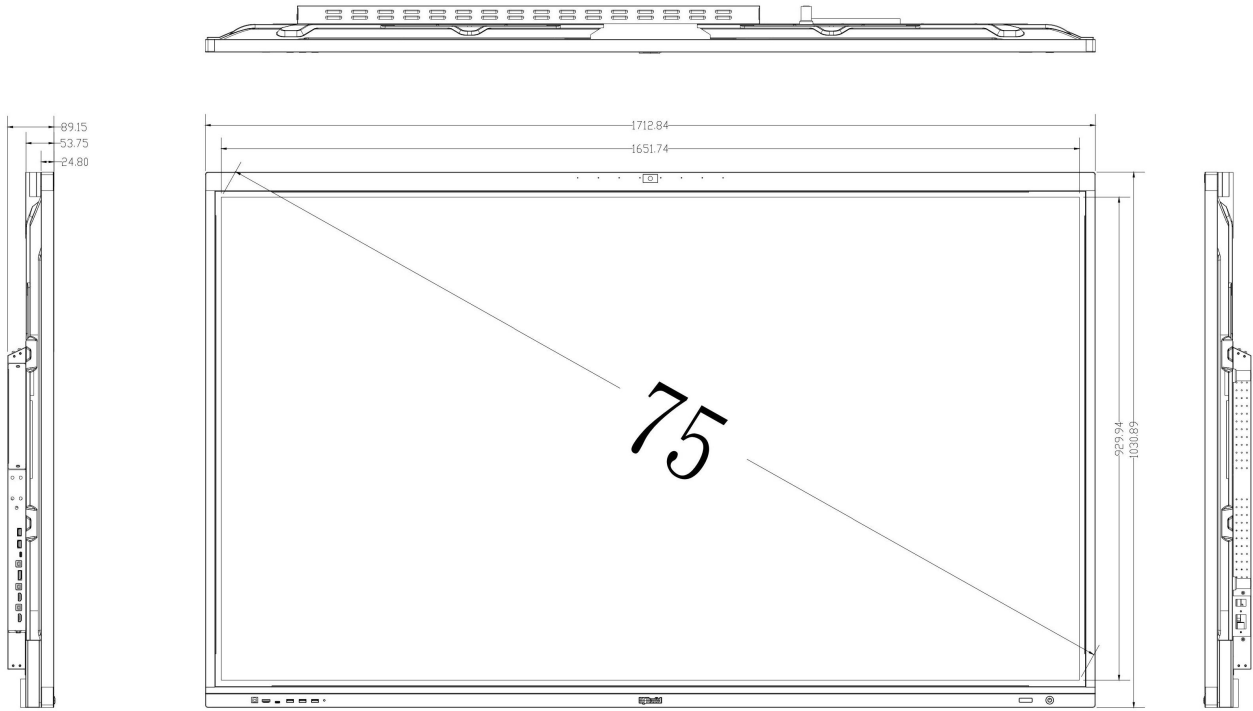



IQTouch TE1100 Pro 86inch Dimension

