

# LCD CART INSTALLATION GUILD

Model NO.: DT-E

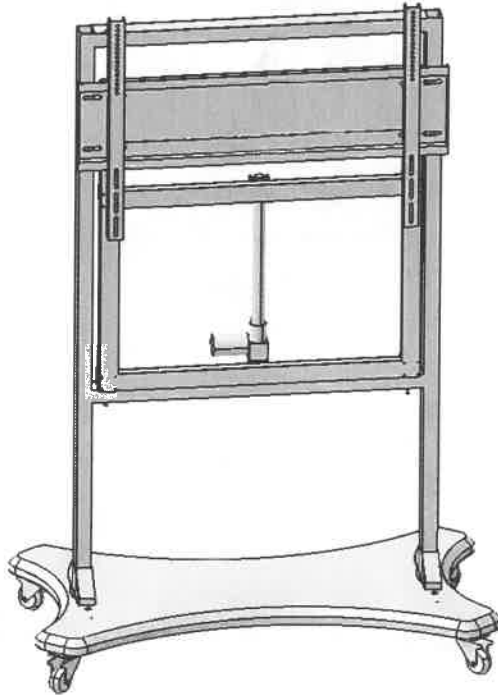

To ensure the mobile stand can be installed correctly, please read this installation guild carefully and keep it properly for future reference.

You can also authorize some professional installation company to install this mobile stand for you. This mobile stand can be used in house, office etc.

## **I. Security Warning**

1. Read and understand the whole instruction and operate exactly as the guild instructs.
2. Please ask professionals to install it and there should be 2 people assembling and adjusting it at least.
3. Make sure this product be used on flat floor and won' t be hit hard. If it' s damaged, please stop using it or you need to take responsibility for related consequence.
4. We will not be responsible for damage and lost causing by incorrect installation and operations.

## II. Installation Sequence and Component Structure Drawing

### Step 1

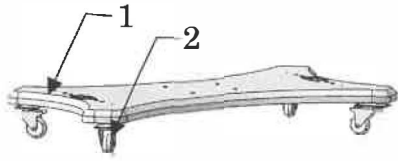

NO.	Name	QTY
1	Under frame	1
2	wheels	4
Required screws	M8×16hex screw washer	16

### Step 2

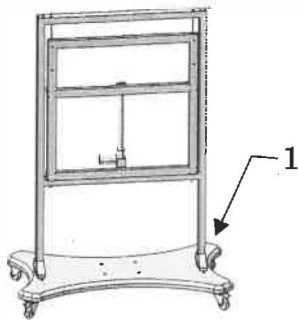

NO.	Name	QTY
1	Lifting device	1
Required screws	M10×25 hex screw and washer	4

### step 3

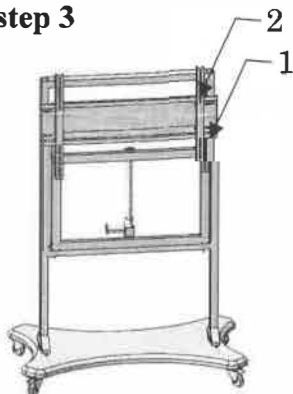

NO.	Name	QTY
1	TV hanging board	1
2	TV hooks	2
Required screws	M8×30 hex screw	4
	M8*16 hex nut	4
	Φ8 washer	8

## III adjustment method

